

FORM No. 1.

Joseph Rutter

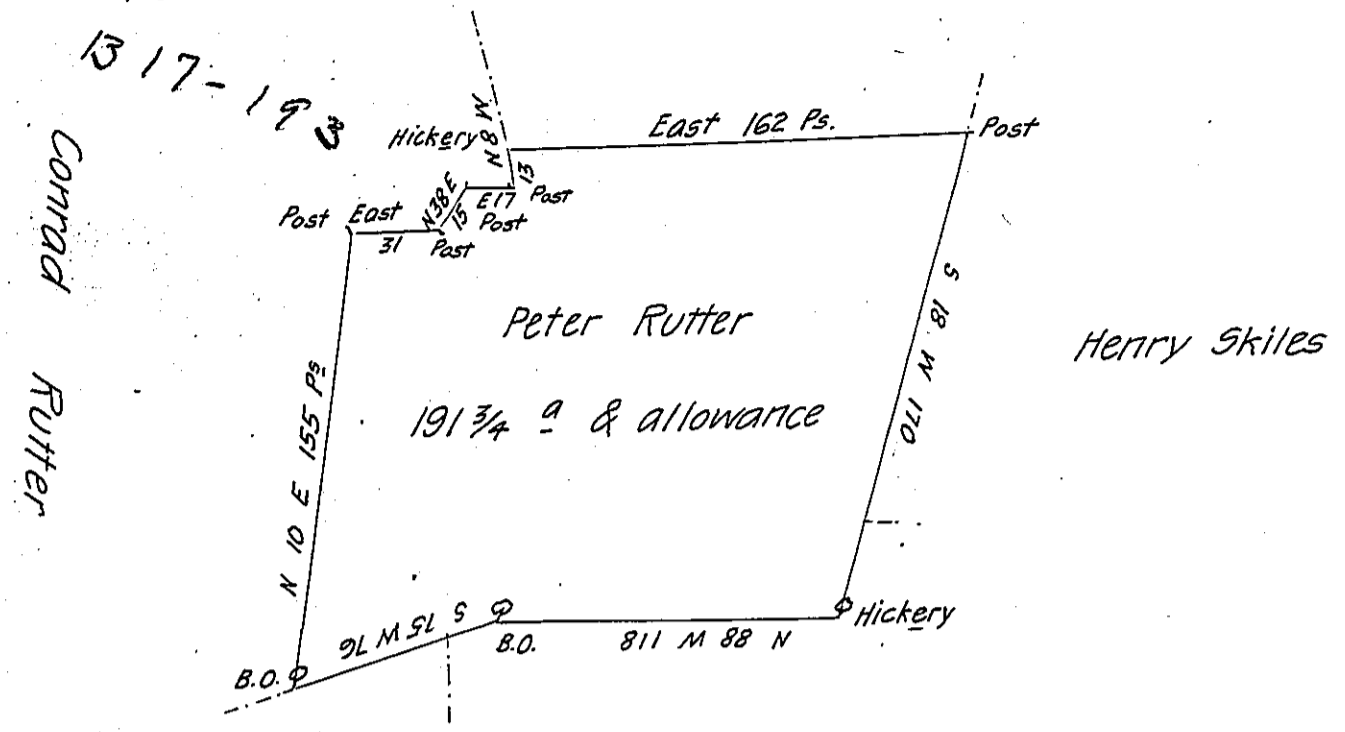

The Draught of a Tract of Land situate in Leacock Town-
 ship Lancaster County Belonging to Peter Rutter being part of a Tract of
 588 Acres and Allowance which by Warr^t of the third day of January
 1733 to his Father Conrad Rutter @ Surveyed the 6th of the 1st mo. 1761.

P—
 Berja Parvin—

IN TESTIMONY that the above is a copy of the original remaining on file in
 the Department of Internal Affairs of Pennsylvania, made
 conformably to an Act of Assembly approved the 16th day of
 February, 1833, I have hereunto set my Hand and caused
 the Seal of said Department to be affixed at Harrisburg,
 this.....twenty first.....day of.....June.....1906

Lea O. Parvin
 Secretary of Internal Affairs.